



AIESISTEM

Your home around the world



www.aiesistem.com

Data sheet

TYPOLOGY	Semi-integrated
CONSTRUCTION	Monocoque in fibreglass, gelcoat finish, painted to match the cab-wall thickness mm 30
MECHANICAL BASIS	Chassis cab Fiat Ducato 140/ Renault Master 145
EQUIPMENT	Uprated alternator, ABS, long arm rearview, 90 l fuel tank, driver and passenger airbags, centralized closing, electric windows, Bluetooth USB radio, Cruise Control
MEASURES	External width mm 2200, height mm 2860, internal height mm 1960
OVERALL MASS	3500kg
HEATING	Truma Combi C4 4000w (up to m 6)-C6 6000w (from m 6.40), with ducted air
REFRIGERATOR	Dometic trivalent fridge lt 98-10 series
ELECTRICAL SYSTEM	AGM 100 ah service battery, LED lighting, CBE multifunction control panel ducted system
WINDOWS/PORTHOLES	Seitz windows and Heki skylight with mesh screen and darkening system
COOKTOP	2 burners with lid lowered flush top
CYLINDER COMPARTMENT	Fiberglass locker for 2 cylinders with regulator
TOILET COMPARTMENT	Separate Fiberglass Shower Enclosure and Fiberglass Shower Tray
WC	Dometic removable cassette with swivel cup
STEP	Integrated fiberglass interior and electric external step
WATER SYSTEM	John Guest system - Shurflo pump and expansion vessel



- Seamless monocoque
- 10-year leakage guarantee
- Maximum silence while travelling
- High level insulation
- Automotive line
- LED technology
- Washable anti-tank and fire-proof wall covering
- Fiberglass shower tray and compartment
- Extremely low total weight



Our models



570LF m 5.75

Tare weight Kg 2650

Permitted persons 4 - 3 in bed (2000x1300+1800x800)

Wheelbase: 3450 Fiat - 3682 Renault

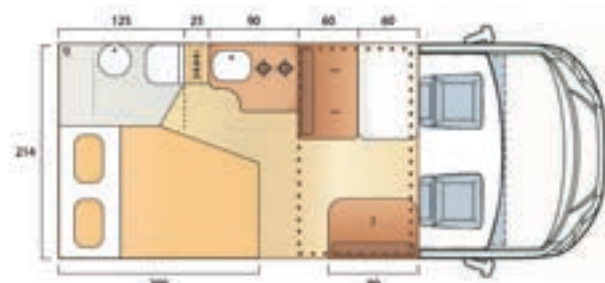

600FB m 6.00 Fiat - 6.06 Renault

Tare weight Kg 2700

Permitted persons 4 - 3 in bed (2000x1300+1850x1150)*

Wheelbase: 3450 Fiat - 3682 Renault

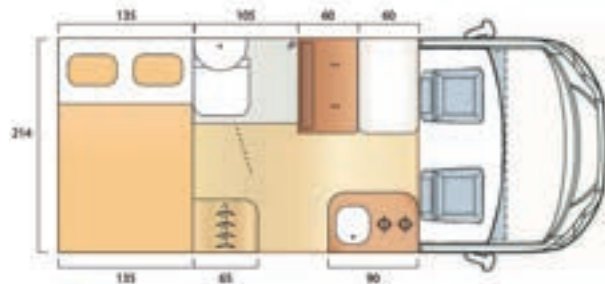

600G m 6.00 Fiat - 6.06 Renault

Tare weight Kg 2700

Permitted persons 4 - 3 in bed (2140x1350+1800x800)

Wheelbase: 3450 Fiat - 3682 Renault

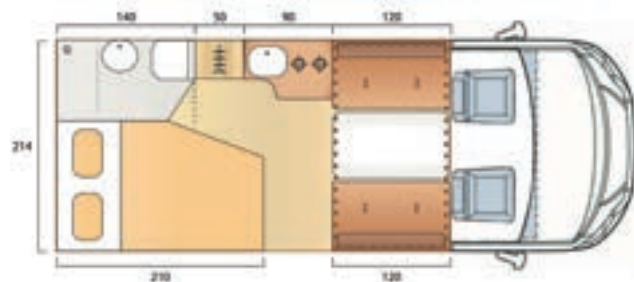

640FB m 6.40 Fiat - 6.46 Renault

Tare weight Kg 2850

Permitted persons 4 + 4 in bed (2100x1300+2040x1200)*

Wheelbase: 4035 Fiat - 4332 Renault

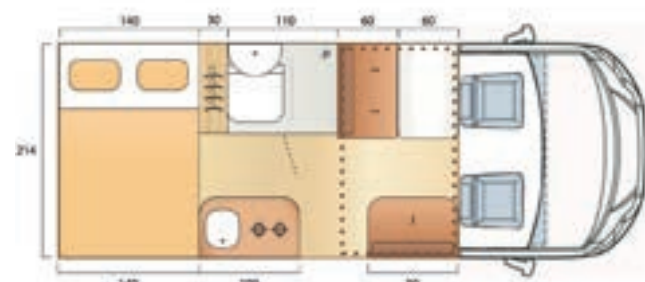

640G m 6.40 Fiat - 6.46 Renault

Tare weight Kg 2850

Permitted persons 4 + 4 in bed (2140x1400+1850x1150)*

Wheelbase: 4035 Fiat - 4332 Renault



640LC m 6.40 Fiat - 6.46 Renault

Tare weight Kg 2850

Permitted persons 4 + 4 in bed (2140x800+1950x1300)

Wheelbase: 4035 Fiat - 4332 Renault

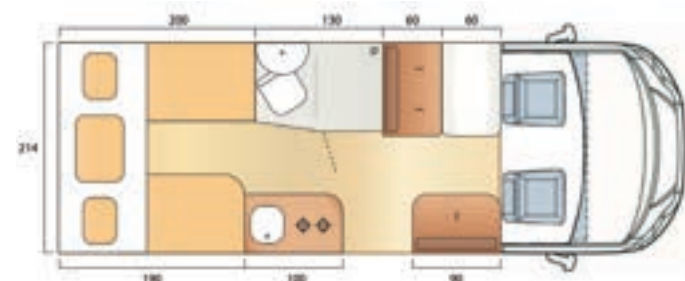

690LG m 6.98 Fiat - 6.98 Renault

Tare weight Kg 2950

Permitted persons 4 + 3 in bed (2000x800+1900x800+1800x800)

Wheelbase: 4035 Fiat - 4332 Renault

*The fold-down bed is optional.



THE ADVANTAGES OF FIBERGLASS

Our fiberglass monocoque has been produced for over 20 years using a single mould, without components assembled subsequently.

Remarkable are the advantages of the fiberglass monocoque that over time totally cancel the higher costs incurred at the purchase:

- Significantly **higher SAFETY** than traditional assembled structures thanks to the robustness and impact resistance. The increased flexibility especially absorbs bumps, reducing the negative effects on the structure and consequently the risks to the passenger compartment.
- **TOTAL ABSENCE OF INFILTRATION AND MAXIMUM INSULATION** thanks to the absence of joints and thermal points.
- Both front and side, **MAXIMUM AERODYNAMICS** makes the vehicle safer to drive, more stable, and faster with significant reductions in consumption due to the better drag coefficient.
- **EASY REPAIR:** In the event of an accident, it is not necessary to replace the entire wall, as in the case of structures assembled with panels, but you can quickly and economically intervene only on the damaged part from the outside.



AIESISTEM

11 Fiorina Street, - 37026
Settimo di Pescantina, VR

www.aiesistem.com
info@aiesistem.com
Tel. 045 6703337

Aiesistem reserves the right to change at any time and without notice the characteristics and the equipment of the vehicles in this catalogue.