

LATTONERIE PER LAMIERE COPPO

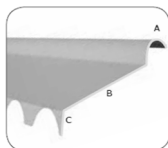

**Semicolmo
fustellato**
Colori: rosso tegola

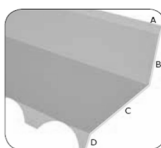

**Falda contromuro
fustellata**
Colori: rosso tegola

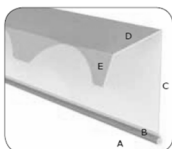

**Falda posteriore
fustellata**
Colori: rosso tegola

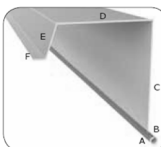

Falda laterale
Colori: rosso tegola

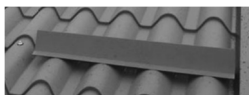

Fermaneve
Colori: rosso tegola



Frontalino
Colori: rosso tegola

FISSAGGI PER COPPO

Viti per ferro

-  Autoperforante
-  Chiave Esagonale 10
-  Capacità di foratura Max 6mm
-  Pre-foro non necessario
-  Velocità di foratura 1000-1800 rpm

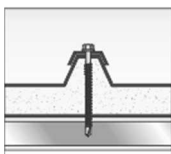

Viti per legno

-  Pre-foro non necessario Max 1mm
-  Chiave Esagonale 10

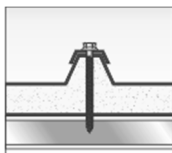

Rondelle in Epdm



Rondella sottotesta



Cappellotti

